

FORM NO 1.

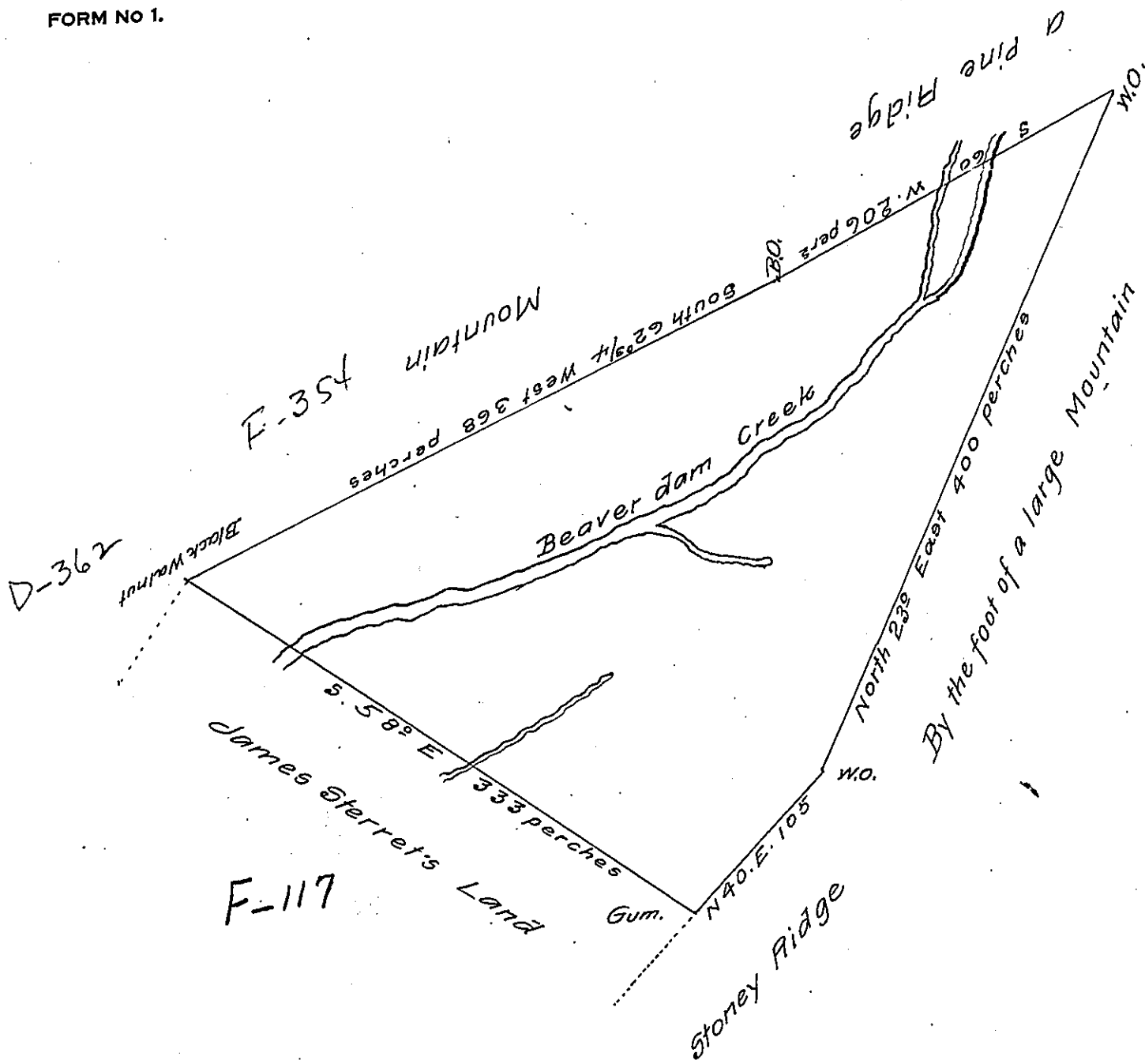

A Draught of a Tract of land situate on the Beaver Dam Creek a Branch of Frankstown Creek about five miles from Frankstown in the County of Cumberland containing Five hundred and fifteen acres and twenty perches and the usual allowance of six acres p<sup>ct</sup> for roads &c.<sup>s</sup> Surveyed the 18<sup>th</sup> day of June 1765 to Samuel and Robert Johnson in pursuance of a Warrant dated the 31<sup>st</sup> day of May 1762

*R* Richard Tea Dep<sup>y</sup> Survey<sup>r</sup>

To John Lukens Esq<sup>r</sup>  
Survey<sup>r</sup> Gen<sup>l</sup>

IN TESTIMONY that the above is a copy of the original remaining on file in the Department of Internal Affairs of Pennsylvania, made conformably to an Act of Assembly approved the 16th day of February, 1833, I have hereunto set my Hand and caused the Seal of said Department to be affixed at Harrisburg, this fourteenth day of November 1907

*Henry Harshbarger*  
Secretary of Internal Affairs.